

SHIMANO

1987 REPAIR MANUAL

Shimano American Corporation, One Shimano Drive, Irvine, CA 92714

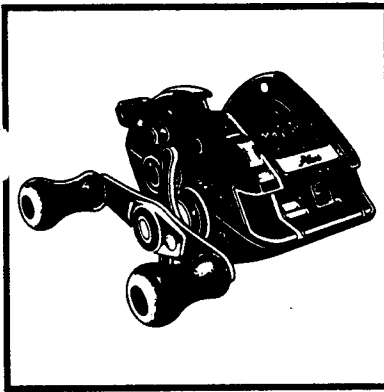

EXPLODED PARTS VIEW

Bantam
Magnumlite 2001GT Plus

* Please check the head of the "Magnetic Control Dial" here to see whether you have an old or new-type reel.

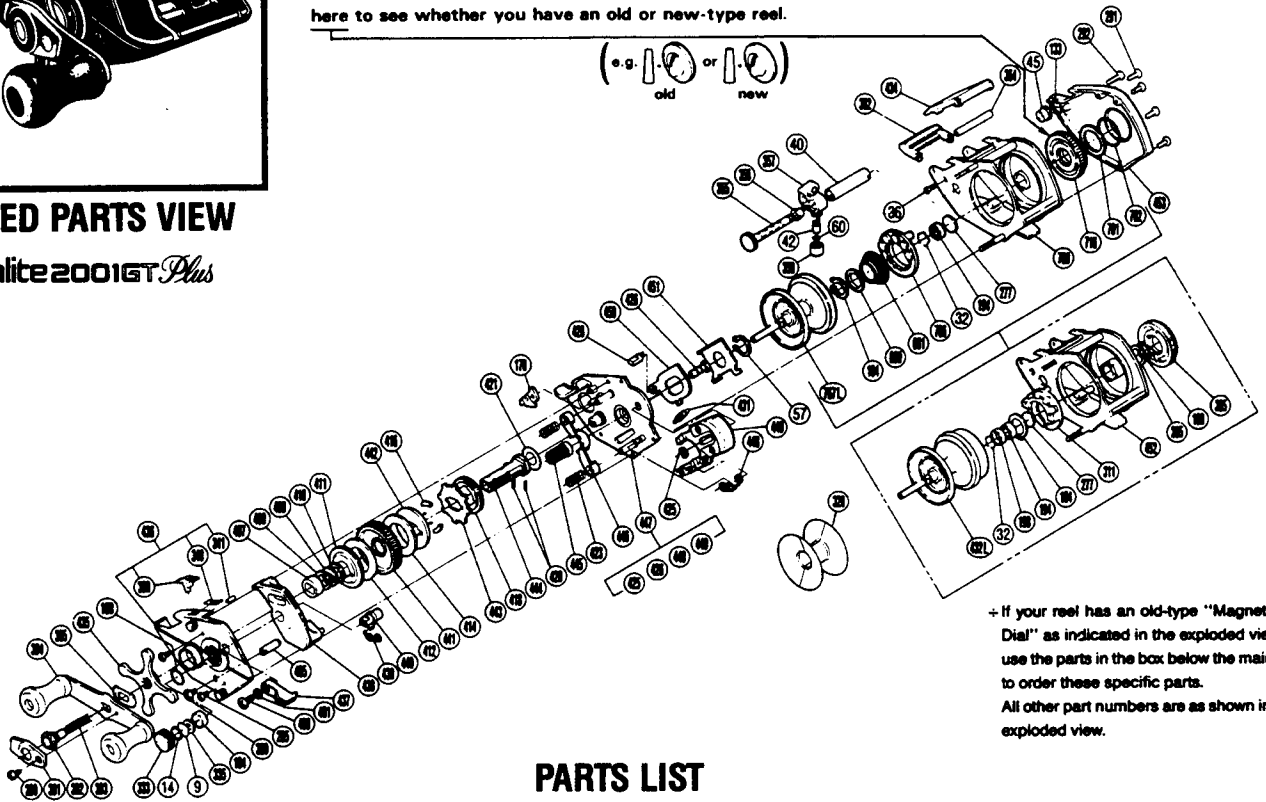
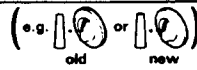

+ If your reel has an old-type "Magnetic Dial" as indicated in the exploded view, use the parts in the box below the main dial to order these specific parts. All other part numbers are as shown in the exploded view.

PARTS LIST

PART # DESCRIPTION

BNT 0009	Spacer (A)
BNT 0014	Friction Washer (B)
BNT 0032	Bearing Retainer
BNT 0036	Stabilizer Bar Screw (A) (S)
BNT 0040	Level Wind Guard
BNT 0042	Line Guide Pawl
BNT 0045	Worm Bearing (B)
BNT 0060	Spacer (Optional)
BNT 0133	Worm Shaft Retainer
BNT 0170	Anti-Reverse Pawl (Assembly)
BNT 0184	Magnet Retainer Lock
BNT 0188	O Ring
BNT 0194	Ball Bearing
BNT 0198	Bearing Spacer
BNT 0265	Spacer (Optional)
BNT 0277	Spacer (B)
BNT 0280	Handle Screw "B"
BNT 0285	Set Plate Screw
BNT 0291	Side Plate Screw
BNT 0292	Stabilizer Bar Screw (B)
BNT 0311	Magnet Retainer (Assembly)
BNT 0328	V Spool Converter
BNT 0333	Cast Control Cap
BNT 0335	Bearing Washer (A)
BNT 0340	Switch Spring
BNT 0341	Switch Spring Lock
BNT 0355	Worm Shaft Assembly
BNT 0356	Worm Bearing "A"
BNT 0357	Line Guide (Assembly)
BNT 0358	Pawl Cap

PART # DESCRIPTION

BNT 0362	Level Wind Protector
BNT 0364	Stabilizer Bar
BNT 0365	Magnetic Control Dial
BNT 0391	Handle Screw Lock Plate
BNT 0392	Handle Screw "A"
BNT 0393	Drive Shaft Spring
BNT 0394	Handle Assembly
BNT 0395	Friction Washer "A"
BNT 0398	Anti-Reverse Switch
BNT 0399	Retractor Guide Screw (Large Head)
BNT 0400	Fightin' Lever Screw
BNT 0401	Fightin' Lever Screw Washer
BNT 0405	Retractor Guide
BNT 0407	Bushing "B"
BNT 0408	Friction Washer "B"
BNT 0409	Drag Spring Washer
BNT 0410	Friction Washer "C"
BNT 0411	Key Washer "A"
BNT 0412	Drag Washer
BNT 0414	Drive Shaft Washer "B"
BNT 0416	Gear Protector Rubber
BNT 0418	Level Wind Drive Gear
BNT 0420	Drive Shaft Lock
BNT 0421	Drive Shaft Washer "A"
BNT 0423	Yoke Spring
BNT 0425	Clutchbutton Lock
BNT 0426	Fightin' Lever Cam
BNT 0428	Slide Cam
BNT 0431	Slide Plate Spring

PART # DESCRIPTION

BNT 0432L	Spool Assembly
BNT 0434	Thumb Rest
BNT 0435	Star Drag Assembly
BNT 0436	Right Side Plate Assembly
BNT 0437	Fightin' Lever
BNT 0438	Clutch Button Attachment
BNT 0439	Joint Cam Yoke Spring
BNT 0440	Joint Cam Yoke
BNT 0441	Drive Gear
BNT 0442	Key Washer "B"
BNT 0443	Anti-Reverse Ratchet
BNT 0444	Drive Shaft
BNT 0445	Pinion Gear Assembly
BNT 0446	Yoke
BNT 0447	Set Plate Assembly
BNT 0448	Retractor Spring
BNT 0449	Clutch Button
BNT 0450	Slide Plate
BNT 0451	Slide Plate Cover
BNT 0452	Frame Assembly
BNT 0453	Left Side Plate
BNT 0660	Spring Spacer
BNT 0661	Magnet Retainer Spring
BNT 0701	Thrust Washer Spacer (Optional)
BNT 0702	Dial O Ring
BNT 0706	Magnet Retainer
BNT 0716	Magnet Control Dial
BNT 0767L	Spool Assembly
BNT 0769	Frame Assembly